

# OmniVR, Synchrony, OmniTour Packaging Instructions

A Shipping Department Work Instruction

October 25<sup>th</sup>, 2024

Manager, Service Center

Effective Date: 10/01/2013

Release Date: See Master Control

WI-0066 (4)

## Table of Contents

1. Packaging Instructions (300600C) .....	3
2. Packaging Instructions (300800T) .....	4
3. Packaging Instructions (300800A & 300800E) .....	7
4. Where Posted .....	8
5. Revision History .....	8

**Security Level: Medium | Confidential Records**

This document is the property of Accelerated Care Plus and must be accounted for. Information herein is considered confidential. Do not reproduce it, reveal it to an unauthorized person or send it outside of Accelerated Care Plus without written authorization from Accelerated Care Plus. This printed document is uncontrolled unless stamped.

## 1. Packaging Instructions (300600C)

- 1.1 Wrap bubble wrap around the keyboard and secure it with the blue protective tape
- 1.2 Apply protective tape to the bottom shelf and base to prevent damages
- 1.3 Place a cardboard skid on a 40X48 pallet along with a packaging block for the VR to stand on
- 1.4 With assistance, lift the VR onto the packaging block
- 1.5 Band the VR and block to the pallet in the two locations show below, also include protective corners to prevent damage to the device



- 1.6 Place an eggshell foam pad behind the VR allowing the monitor to sit on to help prevent any shipping damages
- 1.7 Band the monitor to the pallet and VR in the locations below, apply protective corners to each area the band is in contact with the VR

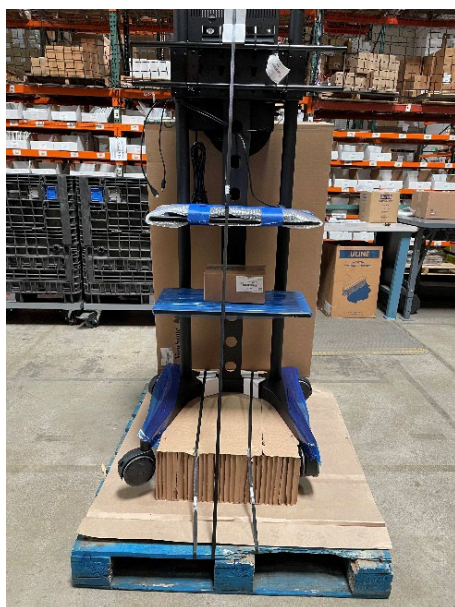

### Security Level: **Medium** | Confidential Records

This document is the property of Accelerated Care Plus and must be accounted for. Information herein is considered confidential. Do not reproduce it, reveal it to an unauthorized person or send it outside of Accelerated Care Plus without written authorization from Accelerated Care Plus. This printed document is uncontrolled unless stamped.

- 1.8 Place a dust cover over the VR and band it to the pallet with the two locations shown below, apply protective corners to add strength to the box



- 1.9 Place the asset tag label on the top left corner

- 1.10 Place a "Deliver to Rehab" Label on top left corner right under the Asset tag label

## 2. Packaging Instructions (300800T)

- 2.1 Place the accessories below in a plastic bag, wrapped in bubble wrap and placed in a 9x6x4 box

- 2.1.1 AAA two pack battery x2

- 2.1.2 TV remote x1

- 2.1.3 Air mouse x1

- 2.1.4 12" Velcro strap x2

- 2.1.5 8" Velcro strap x2

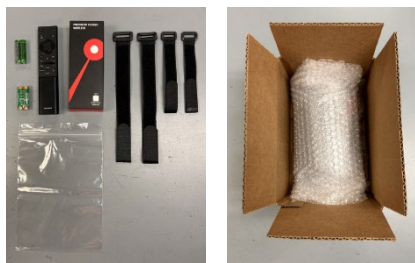

- 2.2 Stack the laptop, 9x6x4 accessory box and the trip mat on the shelf and secure them with protective film.

- 2.3 Wrap the laptop armature and secure it under the monitor bracket.



### Security Level: **Medium** | Confidential Records

This document is the property of Accelerated Care Plus and must be accounted for. Information herein is considered confidential. Do not reproduce it, reveal it to an unauthorized person or send it outside of Accelerated Care Plus without written authorization from Accelerated Care Plus. This printed document is uncontrolled unless stamped.

2.4 Secure the power strip cord with protective film to the OmniTour stand.

2.5 Place a cardboard skid on a 40X48 pallet along with a packaging block for the Tour to stand on

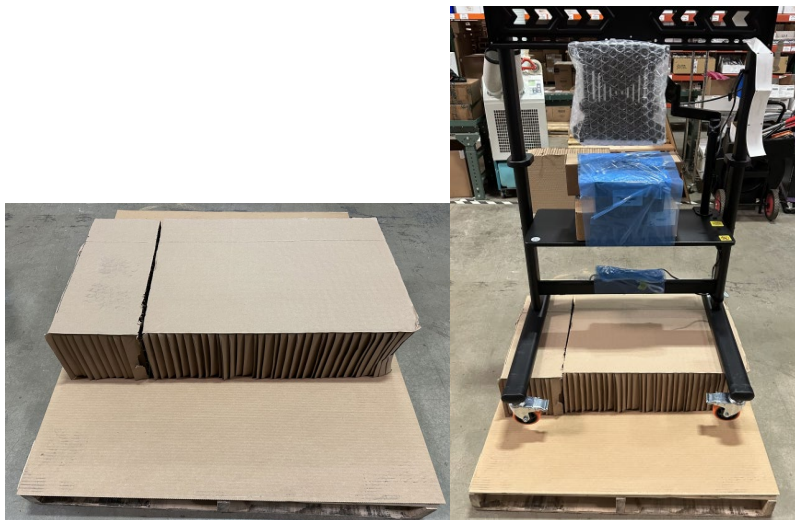

2.6 With assistance, lift the Tour onto the two pre-cut packaging blocks

2.7 Band the Tour and blocks to the pallet in the two locations shown below, also include protective corners to prevent damage to the device



**Security Level: Medium | Confidential Records**

This document is the property of Accelerated Care Plus and must be accounted for. Information herein is considered confidential. Do not reproduce it, reveal it to an unauthorized person or send it outside of Accelerated Care Plus without written authorization from Accelerated Care Plus. This printed document is uncontrolled unless stamped.

- 2.8 Band the monitor to the pallet and Tour in the locations below, apply protective corners to each area the band is in contact with the Tour
- 2.9 Place the asset tag label on the top left corner
- 2.10 Place a “Deliver to Rehab” Label on top left corner right under the Asset tag label



**Security Level: Medium | Confidential Records**

This document is the property of Accelerated Care Plus and must be accounted for. Information herein is considered confidential. Do not reproduce it, reveal it to an unauthorized person or send it outside of Accelerated Care Plus without written authorization from Accelerated Care Plus. This printed document is uncontrolled unless stamped.

### 3. Packaging Instructions (300800A & 300800E)

- 3.1 Start by placing a VR insert into a 24X40 Pallet
- 3.2 Cut off the smaller section of the pre-cut line on the packaging block



- 3.3 Place the Synchrony stand onto the packaging block and band the device to the pallet while using protective corners to prevent any damage
- 3.4 After you band the stand make sure you adjust the height of the stand to the lowest point possible
- 3.5 Place the monitor on the top shelf of the stand and secure it with stretch wrap



- 3.6 Place the dust cover over the device and secure it to the pallet with two bands and 4 protective corners
- 3.7 Apply the device label and rehab sticker to the top left of the dust cover

#### Security Level: **Medium** | Confidential Records

This document is the property of Accelerated Care Plus and must be accounted for. Information herein is considered confidential. Do not reproduce it, reveal it to an unauthorized person or send it outside of Accelerated Care Plus without written authorization from Accelerated Care Plus. This printed document is uncontrolled unless stamped.

## 4. Where Posted

4.1 See Master Control

## 5. Revision History

5.1 See Master Control